

REVISIONS				
DRG ISS No.	RELEASE DOC.	ISSUE DATE:	DRG CHANGE	APP BY:
1	DRN 13776	13.4.22	NEW	

NOTES:

- THIS DRAWING DETAILS A 180 PAX CONFIGURATION ON THE OPERATOR'S A320 AIRCRAFT AND SHOULD BE READ IN CONJUNCTION WITH MODIFICATION AES-320-6706 AND MEI-5901.
- SEAT POSITIONS ARE DIMENSIONED TO THE CENTRELINE OF THE SEAT FRONT FOOT STUD LOCKED IN THE SEAT TRACK - SEE DETAIL D, SHT 3.
- ALL SEAT PITCHES ARE TYPICAL FOR BOTH LEFT AND RIGHT SIDES.
- INSTALL PASSENGER SEATS IN ACCORDANCE WITH SEAT CMM 25-26-73.
- THE CENTER AISLE EXCEEDS THE MINIMUM REQUIREMENTS (AS DESCRIBED IN CS 25.815) OF 15 INCHES WIDE UP TO A HEIGHT OF 25 INCHES FROM THE FLOOR AND 20 INCHES WIDE ABOVE 25 INCHES FROM THE FLOOR. REFER TO DETAIL E, SHT 3.
- OUTBOARD SEAT COMPRESSIBLE CUSHIONS AT ROWS 12 & 13 MUST NOT EXCEED A HEIGHT OF 18.8" FROM FLOOR LEVEL, WHEN EGRESS PATH IS AT LEAST 10".
- HEADSTRIKE OF FRONT ROW PASSENGER IS PREVENTED BY MAINTAINING A CLEARANCE OF 35" MEASURED FROM CUSHION REFERENCE POINT (CRP) TO FWD BULKHEAD. THIS DISTANCE ALSO TAKES INTO ACCOUNT LITERATURE POCKETS AND OTHER FITMENTS ON THE BULKHEAD - SEE DETAIL A, SHT 4.
- A PLACARD MUST BE INSTALLED ON EACH OVERWING EXIT HATCH STATING THE WEIGHT AND OPERATION OF THE HATCH. THE HATCH WEIGHT & OPERATION PLACARD MUST BE READABLE BY ALL PASSENGERS SEATED ADJACENT TO AND FACING THE PASSAGEWAY TO THE EXIT. OPERATIONAL PLACARD MUST BE INSTALLED ON ADJACENT SEAT BACKS TOO.
- EACH PASSAGEWAY TO ALL TYPE C EXITS IS UNOBSTRUCTED AND IS AT LEAST 20" WIDE WITH ADJACENT ASSIST SPACE OF 12" BY 20". FWD CABIN PARTITIONS ARE INSTALLED UNDER CONCURRENT MODIFICATION AES-320-4582. AFT TYPE C EXITS ARE NOT AFFECTED BY THIS MODIFICATION.
- MAKE SURE A FASTEN SEATBELT WHILE SEATED AND LIFEJACKET LOCATION PLACARD IS VISIBLE AT ALL SEAT LOCATIONS.
- MAKE SURE ALL PASSENGER SEATS ARE EQUIPPED WITH (E)TSO APPROVED SEAT BELTS.
- MAKE SURE ALL PASSENGER SEATS ARE EQUIPPED WITH SERVICEABLE AND (E)TSO APPROVED LIFE VESTS.
- TRIM AND INSTALL SEAT TRACK COVER (ITEM 27) AS REQUIRED THROUGHOUT THE CABIN TO SUIT PASSENGER SEATS LAYOUT.
- REFER TO DRAWING 7483-252-320 FOR PSU LAYOUT.
- A/C IS TO BE OPERATED WITH A MINIMUM CABIN CREW OF 4 WITH THIS SEATING LAYOUT.
- EMERGENCY EXIT SEATS (ITEMS 17 AND 19) ARE MODIFIED. REFER TO SERVICE BULLETIN 320_423-12-19 AND MASTER DOCUMENT LIST 320_423-18-02 FOR MODIFICATION DETAILS.
- ALL SEATS:
 - NO BREAKOVER;
 - NO RECLINE;
 - ALL TABLE LATCHES COMPLETELY HIDDEN IN RECESS.

AES
OFFICIAL ISSUE
DATE: 13.04.2022

COPY

A/R	MAP REF	ITEM No.	PART NUMBER	ITEM ISS	KEYWORD/DESCRIPTION	MATERIAL	SPECIFICATION	DIMENSIONS	TREATMENT	OR REMARKS	
		27	ABS5096AA29-12		SEAT TRACK COVER					FN 13	
1		23	3510H989-32-051		TRIPLE, STD, LAST ROW SEAT ASSY RH						
1		21	3510H989-31-051		TRIPLE, STD, LAST ROW SEAT ASSY LH						
2		19	EPA-3510H989-32-011		TRIPLE, STD, EMER. EXIT SEAT ASSY RH					FN 16	
2		17	EPA-3510H989-31-011		TRIPLE, STD, EMER. EXIT SEAT ASSY LH					FN 16	
24		15	3510H989-32-011		TRIPLE, STD SEAT ASSY RH						
24		13	3510H989-31-011		TRIPLE, STD SEAT ASSY LH						
2		11	3510H989-32-082		TRIPLE, STD SEAT ASSY RH						
2		9	3510H989-31-082		TRIPLE, STD SEAT ASSY LH						
1		7	3510H989-32-212		TRIPLE, IAT SEAT ASSY RH						
1		5	3510H989-31-212		TRIPLE, IAT SEAT ASSY LH						
		3									
		-1		-001	180Y PASSENGER SEATING CONFIGURATION						
No. OFF	MAP REF	ITEM No.	PART NUMBER	ITEM ISS	KEYWORD/DESCRIPTION	MATERIAL	SPECIFICATION	DIMENSIONS	TREATMENT	OR REMARKS	
A/D	HAND	MODIFICATION No:		DRAWN BY:		CHECKED BY:		STRUCTURES CVE:			
1	ISS	AES-320-6706		G LEONAVICIUS							
7482-252-320-001	PART NUMBER	SCALE:		DATE:		INTERIOR CVE:		SYSTEMS CVE:			
		AS NOTED AT A3		APRIL 2022							
		LIMITS:		DIMENSIONS IN:		THIRD ANGLE PROJECTION:		EASA APP.: EASA.21J.722			
		± 0.1		INCHES							
SURFACE FINISH:		TITLE:									
N/A		180Y PASSENGER SEATING CONFIGURATION									
<div style="display: flex; justify-content: space-between;"> Form No: AES-138(a) (Issue 2) 20.11.2020 7482-252-320 </div>											
SHEET 1 OF 4 SHEETS											

REVISIONS				
DRG ISS No.	RELEASE DOC.	ISSUE DATE:	DRG CHANGE	APP BY:
1	DRN 13776	13.4.22	NEW	

AES
OFFICIAL ISSUE
DATE: 13.04.2022
COPY

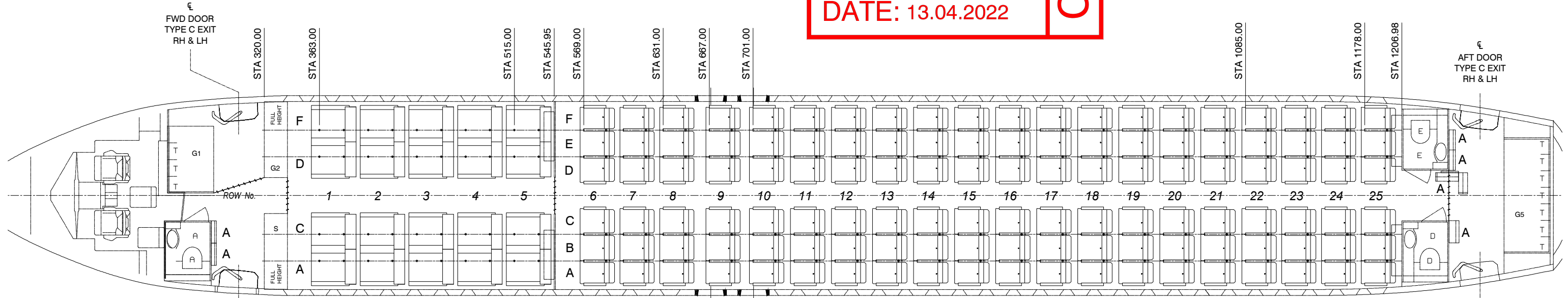

20 B/C & 120 Y/C PASSENGER SEAT
PRE-CONFIGURATION
 AIRBUS A320 PLAN VIEW

STA 668.16
 TYPE III OVERWING E/EXIT
 STA 701.48
 TYPE III OVERWING E/EXIT

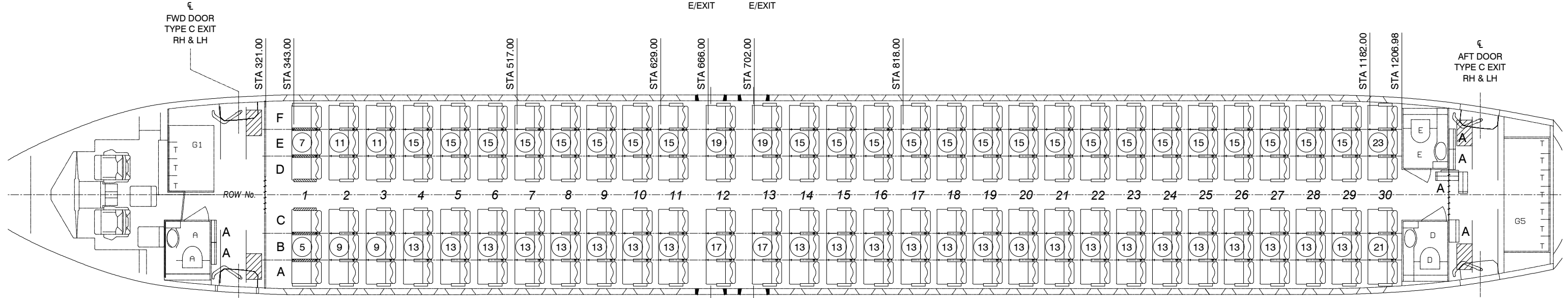

180 Y/C PASSENGER SEATING
POST-CONFIGURATION
 AIRBUS A320 PLAN VIEW

STA 668.16
 TYPE III OVERWING E/EXIT LH & RH
 STA 701.48
 TYPE III OVERWING E/EXIT LH & RH

©2022 ALL RIGHTS RESERVED. THE INFORMATION CONTAINED HEREIN IS PROPRIETARY TO DOA AESGLOBAL LIMITED (AEROSPACE ENGINEERING SOLUTIONS) AND SHALL NOT BE REPRODUCED OR DISCLOSED WITHOUT THE OWNERS WRITTEN PERMISSION.

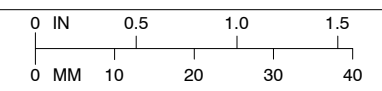

Form No: AES-138(a) (Issue 2) 20.11.2020

DRAWN BY: G LEONAVICIUS	CHECKED BY: 	STRUCTURES CVE: 	DIMENSIONS IN: INCHES	SCALE: 1:80 AT A3	MODIFICATION No: AES-320-6706	THIRD ANGLE PROJECTION: 	EASA APP.: EASA.21J.722	PT No NHA No. OFF EFFECTIVITY
DATE: APRIL 2022	INTERIOR CVE: 	SYSTEMS CVE: 	SURFACE FINISH: N/A	LIMITS: ± 0.1	TITLE: 180Y PASSENGER SEATING CONFIGURATION		7482-252-320 SHEET 2 OF 4 SHEETS	

FOR PARTS LIST SEE SHEET 1

AES
OFFICIAL ISSUE
DATE: 13.04.2022
COPY

REVISIONS				
DRG ISS No.	RELEASE DOC.	ISSUE DATE:	DRG CHANGE	APP BY:
1	DRN 13776	13.4.22	NEW	

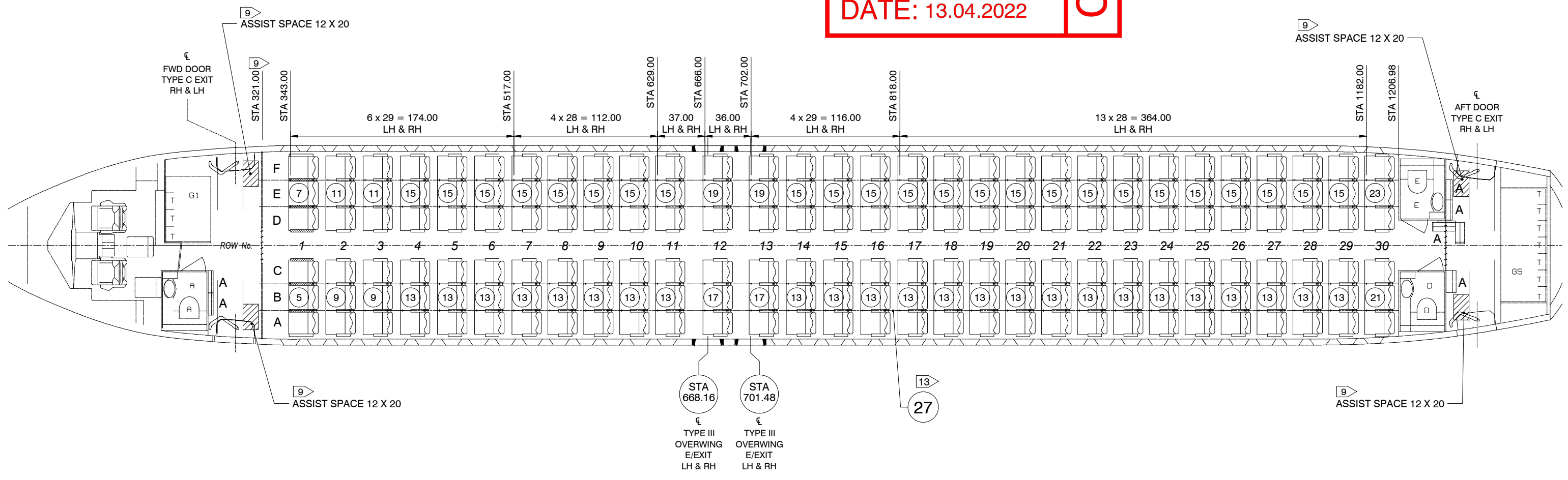

1 180 Y/C PASSENGER SEATING CONFIGURATION
AIRBUS A320 PLAN VIEW

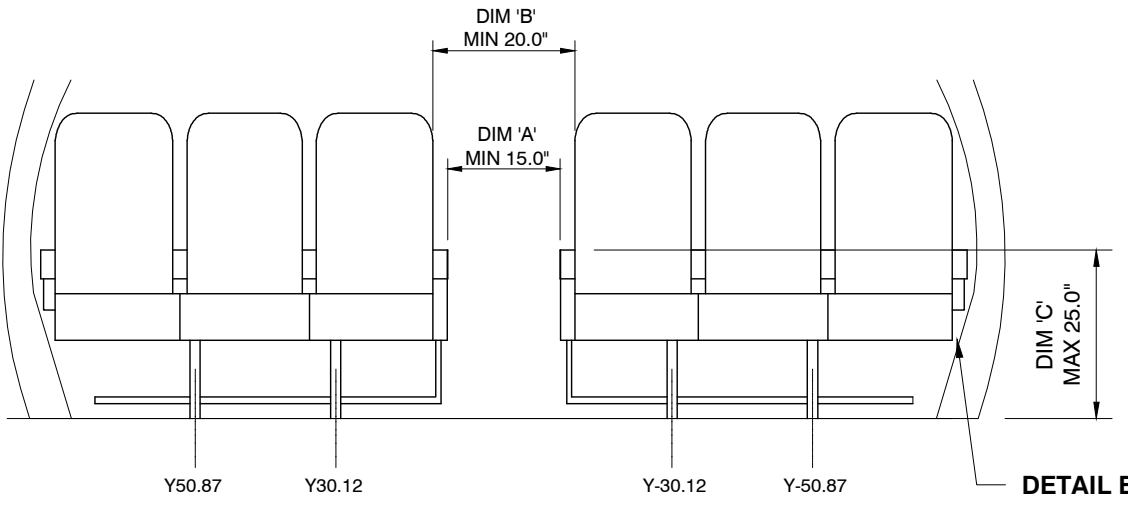

SEAT ROW NUMBER	DIM 'A' (MIN 15.0")	DIM 'B' (MIN 20.0")	DIM 'C' (MAX 25.0")
ROW 1	20.40"	25.50"	24.90"
ROW 2-29	20.40"	25.50"	23.90"
ROW 30	20.40"	25.08"	23.90"

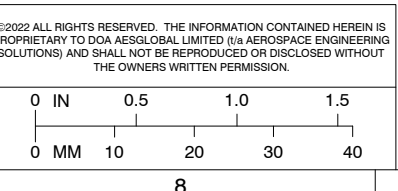
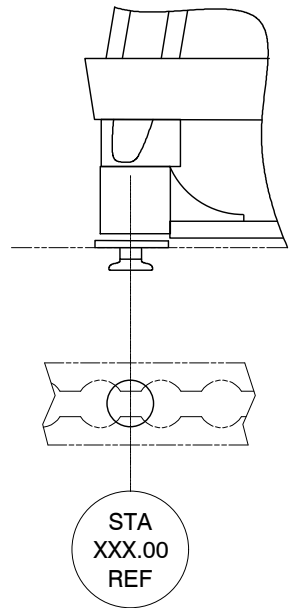

Form No: AES-138(a) (Issue 2) 20.11.2020

DRAWN BY: G LEONAVICIUS	CHECKED BY: 	STRUCTURES CVE: 	DIMENSIONS IN: INCHES	SCALE: 1:80 AT A3	MODIFICATION No: AES-320-6706	THIRD ANGLE PROJECTION: 	EASA APP.: EASA.21J.722	PT No SEE SHEET 1	NHA SEE SHEET 1	No. OFF	EFFECTIVITY
DATE: APRIL 2022	INTERIOR CVE: 	SYSTEMS CVE: 	SURFACE FINISH: N/A	LIMITS: ± 0.1	TITLE: 180Y PASSENGER SEATING CONFIGURATION		7482-252-320		SHEET 3 OF 4 SHEETS		

FOR PARTS LIST SEE SHEET 1

REVISIONS				
DRG ISS No.	RELEASE DOC.	ISSUE DATE:	DRG CHANGE	APP BY:
1	DRN 13776	13.4.22	NEW	<i>[Signature]</i>

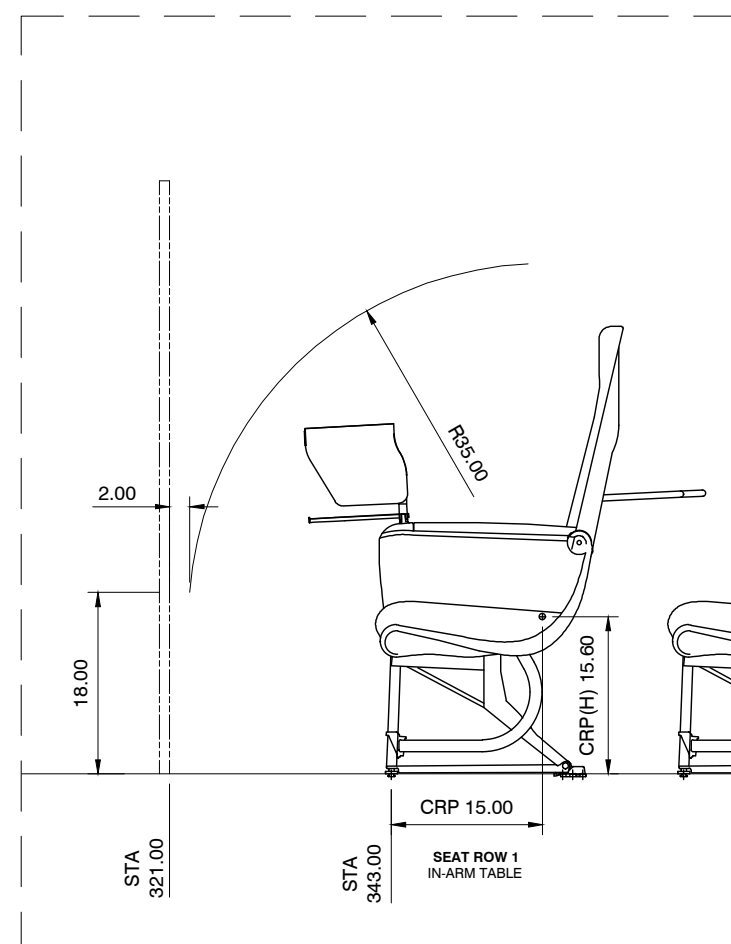

DETAIL A
FRONT ROW SEATS
7

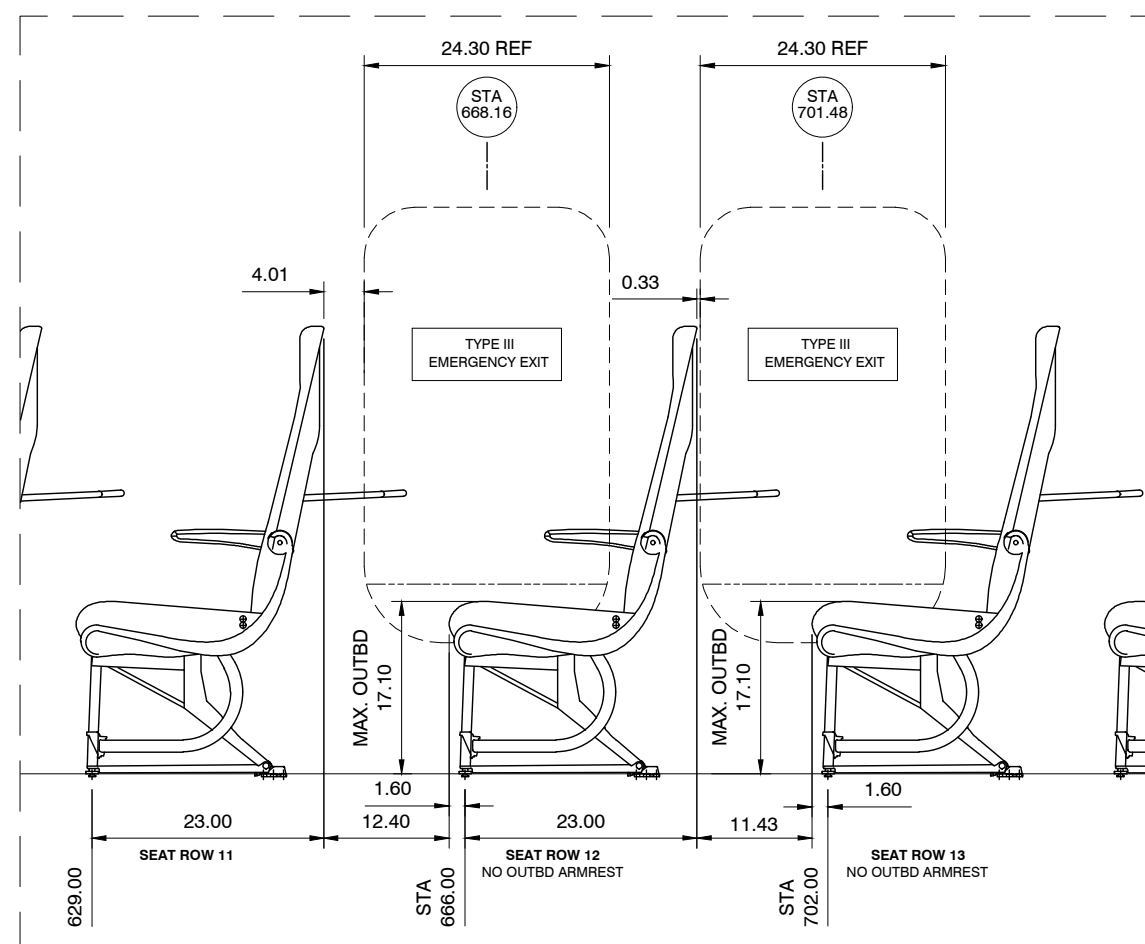

DETAIL B
TYPE III EXIT SEATS
6 8

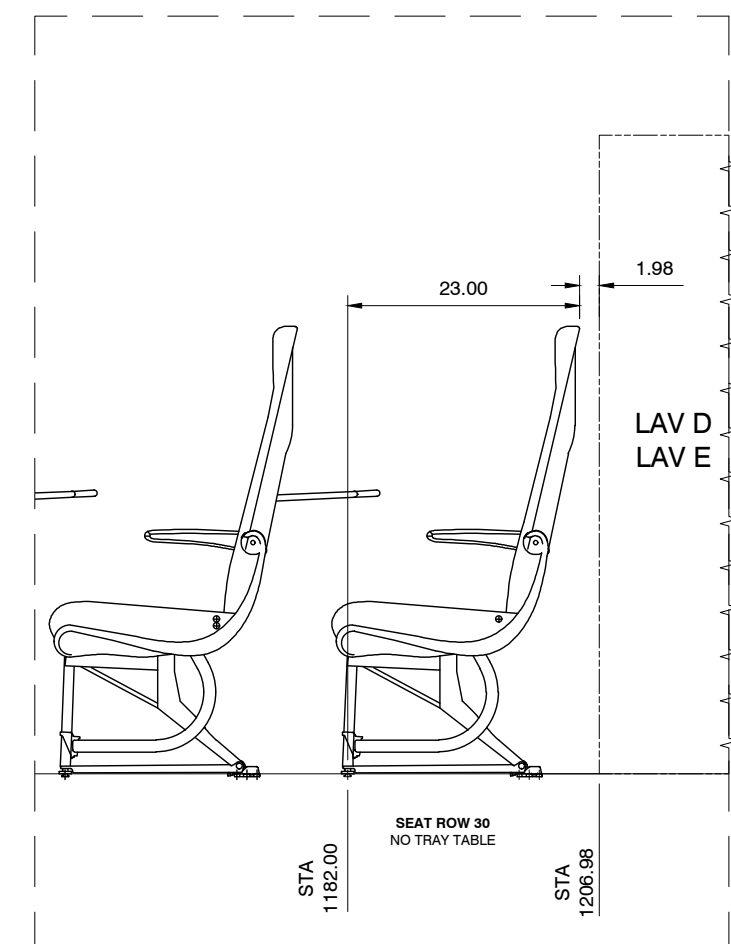

DETAIL C
AFT ROW SEAT

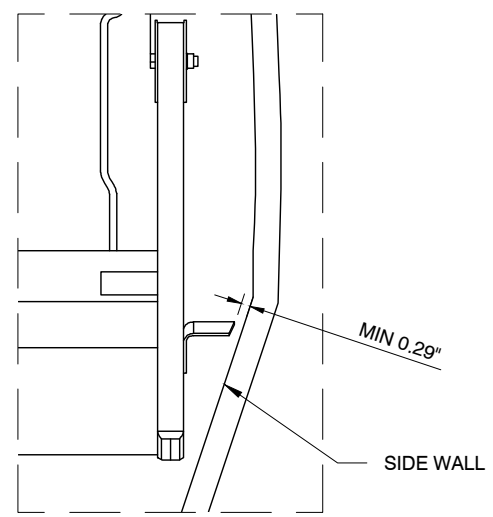

DETAIL E
EM. EXIT SEATS (ROW 12-13)
LH SEAT SHOWN
RH SEAT OPPOSITE

AES
OFFICIAL ISSUE
DATE: 13.04.2022
COPY

©2022 ALL RIGHTS RESERVED. THE INFORMATION CONTAINED HEREIN IS PROPRIETARY TO DOA AESGLOBAL LIMITED (AEROSPACE ENGINEERING SOLUTIONS) AND SHALL NOT BE REPRODUCED OR DISCLOSED WITHOUT THE OWNERS WRITTEN PERMISSION.

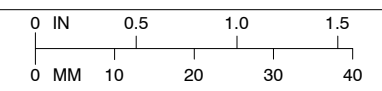

Form No: AES-138(a) (Issue 2) 20.11.2020

DRAWN BY: G LEONAVICIUS	CHECKED BY: <i>[Signature]</i>	STRUCTURES CVE: <i>[Signature]</i>	DIMENSIONS IN: INCHES	SCALE: 1:20 AT A3	MODIFICATION No: AES-320-6706	THIRD ANGLE PROJECTION: 	EASA APP.: EASA.21J.722	PT No SEE SHEET 1	NHA	No. OFF	EFFECTIVITY
DATE: APRIL 2022	INTERIOR CVE: <i>[Signature]</i>	SYSTEMS CVE: <i>[Signature]</i>	SURFACE FINISH: N/A	LIMITS: ± 0.1	TITLE: 180Y PASSENGER SEATING CONFIGURATION		7482-252-320				

FOR PARTS LIST SEE SHEET 1